

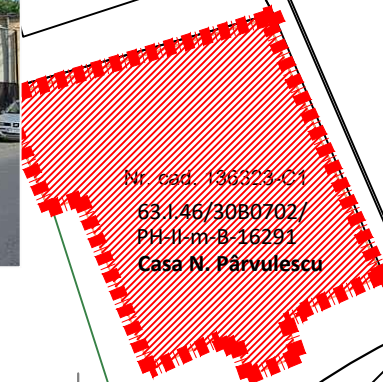

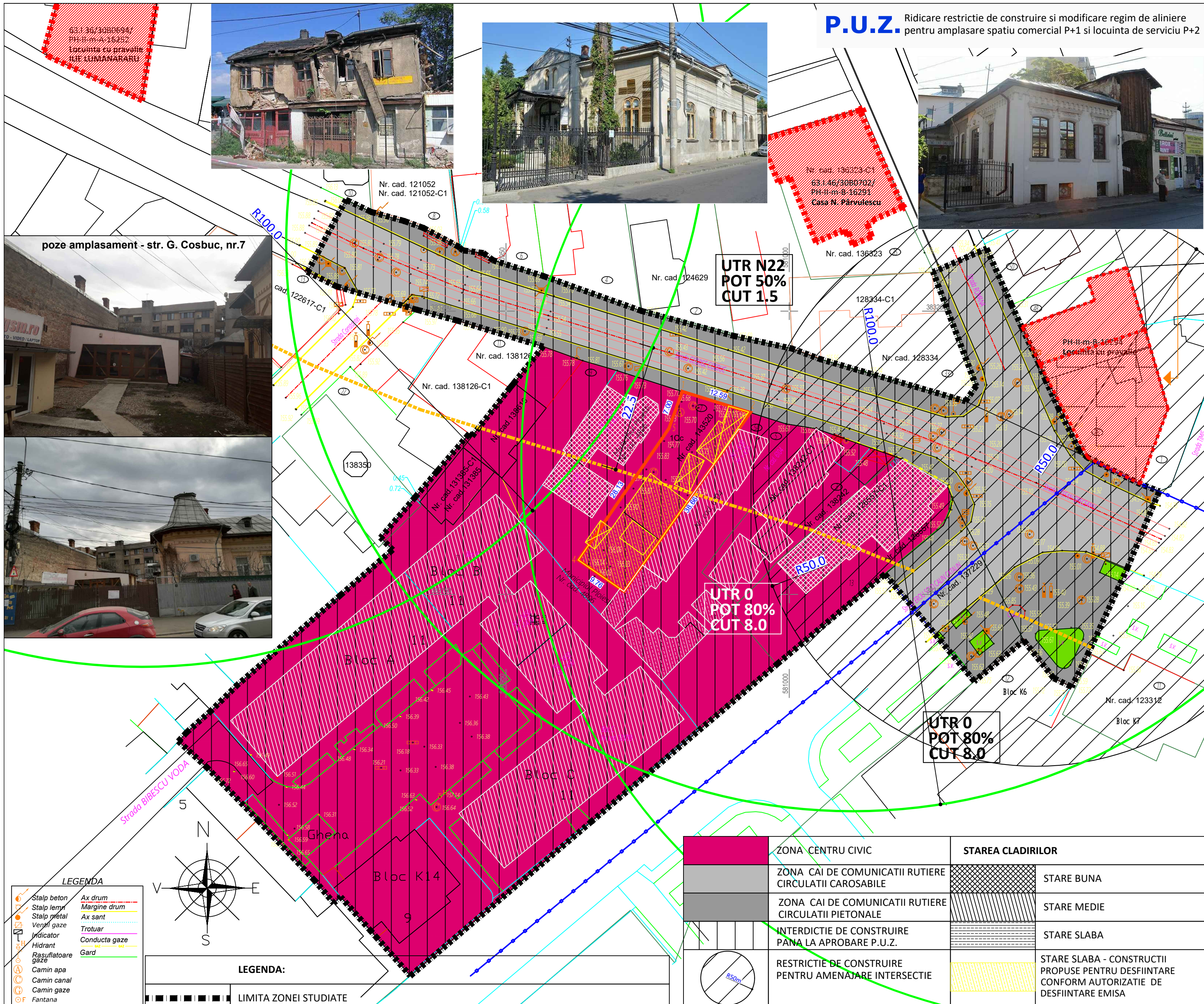



P.U.Z. Ridicare restrictie de construire si modificare regim de aliniere pentru amplasare spatiu comercial P+1 si locuinta de serviciu P+2



poze amplasament - str. G. Cosbuc, nr.7



	ZONA CENTRU CIVIC	STAREA CLADIRILOR	
	ZONA CAI DE COMUNICATII RUTIERE CIRCULATII CAROSABILE		STARE BUNA
	ZONA CAI DE COMUNICATII RUTIERE CIRCULATII PIETONALE		STARE MEDIE
	INTERDICTIE DE CONSTRUIRE PANA LA APROBARE P.U.Z.		STARE SLABA
	RESTRICTIE DE CONSTRUIRE PENTRU AMENAJARE INTERSECIE		STARE SLABA - CONSTRUCTII PROPUSE PENTRU DESFIINTARE CONFORM AUTORIZATIE DE DESFIINTARE EMISA

Verificator/ Expert:		Exigența:		Referat nr./Data:		
<div><div>CUI RO 18618528, J29/940/2006 , jud. Prahova tel: 0768 691 746 roxana.pandele.urb@gmail.com</div></div>			BENEFICIARI: DAVID GABRIEL VLAD si DANIELA GEORGIANA Amplasament: Jud. Prahova, Mun. Ploiesti, str. George Cosbuc, nr.7		PROIECT NR. 10	
CALITATEA ELABORATORILOR	NUME	SEMNATURA	SCARA 1:500	TITLU PROIECT: P.U.Z. - Ridicare restrictie de construire si modificare regim de aliniere pentru amplasare spatiu comercial P+1 si locuinta de serviciu P+2	FAZA P.U.Z.	
SEF PROIECT	urb. ROXANA PANDELE					
PROIECTAT	arh. CRISTINA IVANESCU			TITLU PLANSA: SITUATIA EXISTENTA		PLANSA U.02
DESENAT	arh. CRISTINA IVANESCU			DATA 02.2019		